

Features

- Modern Deck-Mounted Low-Pressure Bathroom Faucet
- Single handle lever controls water flow and temperature
- Brushed Stainless Steel Finish (AISI 316)
- Requires Single-Hole Installation
- Includes Ceramic Disc Cartridge
- Flow Rate: 1.5 GPM
- Spout Reach: 4.1"

S22 T4.10LP



Finishes



Brushed Stainless Steel

Collection S22	Model S22 T4.10LP	Dimensions Metric <i>1 inch = 2.54 cm</i> <i>1 inch = 25.4 mm</i>	 1051 Lea Drive - Collegeville, PA 19426 Tel. 215 513 9400 - Fax 610 831 0215 www.ws bathcollections.com - info@ws bathcollectins.com
-------------------	------------------------	---	---

A diagram of a vertical pipe with a circular flange at the top. Two diagonal lines extend from the flange at 50-degree angles to the vertical centerline.

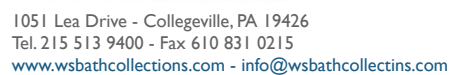

Product Specs Sheets

ASSEMBLY INSTRUCTIONS

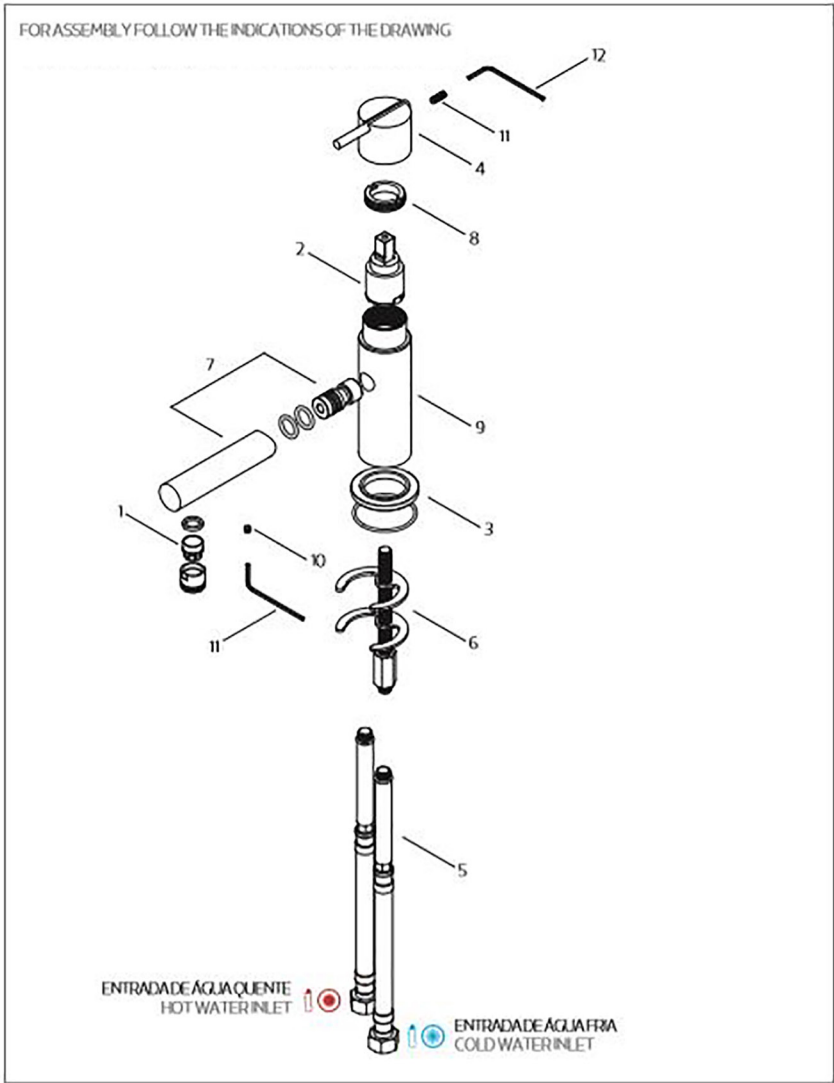

TECHNICAL DATA

Nº	REFERENCE	DESCRIPTION
01	AR4.18 - M18	AERATOR
02	CR4.25 - Ø25MM	CARTRIDGE
03	ES4.45B - Ø45MM	DECK MOUNTED PLATE
04	MA4.35 - Ø35MM	HANDLE
05	—	FLEXIBLE LINK
06	—	FIXING SET
07	—	SPOUT SET
08	—	RETAINING NUT
09	—	MIXER BODY
10	—	UMBRAK SCREW
11	—	UMBRAK KEY

INSTALLATION RECOMENDATIONS

Before installing a tap, it is good to rinse the supply pipes to remove all residues. We also recommend installing the taps with a filter. The installation of the tap must be done with the surface clean and dry. to perform the water pressure test, the taps must be open.

CLEANING AND MAINTENANCE

Cleaning must be done with liquid soap and water. Do not use liquid detergents containing abrasive or acidic substances, abrasive sponges or disinfectants. Incorrect cleaning may permanently ruin the surface of taps.

On color finishings, do not use products containing alcohol, acetone and other solvents.

Collection
S22

Model |
S22 T4.10LP

Dimensions Metric
1 inch = 2.54 cm
1 inch = 25.4 mm

WS[®]
BATH
COLLECTIONS

1051 Lea Drive - Collegeville, PA 19426
Tel. 215 513 9400 - Fax 610 831 0215
www.ws bathcollections.com - info@ws bathcollectins.com